

# DC 3-/4-wire Inductive Block Sensors

## Block housing, 40×40 mm Unicompat



Inductive sensors  
Global DC 3-wire  
DC 3-/4-wire  
Tubular housings  
Block housings  
DC 2-wire  
AC/DC 2-wire  
AC 2-wire  
Special properties  
Analog distance measurement  
Accessories

Housing size	<b>40×40 mm Unicompat</b>	
Installation type (observe instructions in the Basic Information chapter)	Flush	
Rated switching distance $s_n$	<b>20 mm</b>	
Assured switching distance $s_a$	0...16 mm	
Sensing distance	1X	
PNP, NO	<b>Ordering code</b>	<b>BES021W</b>
	Part number	BES Q40KFU-PSC20B-S04G
PNP, complementary	<b>Ordering code</b>	<b>BES0217</b>
	Part number	BES Q40KFU-PAC20B-S04G
Supply voltage $U_B$	10...30 V DC	
Voltage drop $U_d$ at $I_o$ max.	2.5 V	
Rated insulation voltage $U_i$ (protection class)	250 V AC (II)	
Rated operating current $I_o$	200 mA	
Polarity reversal protected/transposition protected/short-circuit protected	Yes/Yes/Yes	
Ambient temperature $T_a$	-25...+70°C	
Switching frequency $f$ max.	50 Hz	
Output function indicator	Yellow LED	
Degree of protection as per IEC 60529	IP 67	
Approvals	CE, cULus	
Material	Housing	PBT
	Sensing surface	PBT
Possible installation variations	Fig. 1...8	
Connection	M12 connector, 4-pin	
Suggested mating cable	BCC M415-0000-1A-003-EX44T2-020	

See technical section (page 963-966) for installation instructions.

For wiring diagram see page 958.

**Additional cable lengths and PUR cable jacket material available on request.**

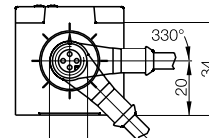
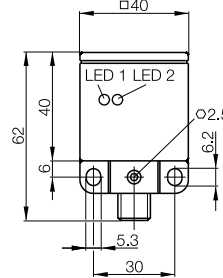

### Row mounting

Flush 80 mm  
Ø 120 mm non-flush

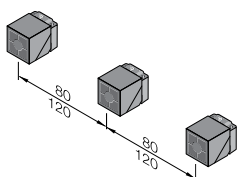

### Permissible installation options

